



LEDOK APP User Manual

Version : V.1.0

Statement

Dear user friend , thanks for choosing SHENZHEN SYSOLUTION TECHNOLOGY CO.,LTD (hereinafter referred to as Xixun Technology) as your LED advertising equipment control system. The main purpose of this document is to help you quickly understand and use the product. We strive to be precise and reliable when writing the document, and the content may be modified or changed at any time without notice.

Copyright

The copyright of this document belongs to Xixun Technology. Without the written permission of our company , no unit or individual may copy or extract the content of this article in any form.

Trademark



is a registered trademark of Xixun Technology.

Update

No	Version	Update	Revise
1	Ver.1.0	Initial Publish	2022.03.22

Documets are subject to change without prior notice.

SHENZHEN SYSOLUTION TECHNOLOGY CO., LTD

Catalog

Install APP Instructions	1
Basic Instructions of the APP	2
Instruction of Local Control	4
1. Detect controller IP address	4
2. Solution List	7
2.1. Add	7
2.2. Schedule for each solution	12
3. Expand	14
3.1. Real-time Text	15
3.2. Scoreboard	16
3.3. Magic cube	16
4. Instructions of Settings	17
4.1. Screenshot	17
4.2. Network	18
4.3. Volume	23
4.4. Brightness	24
4.5. Restart	27
4.6. Screen	28
4.7. Senior	29
4.8. Server	31
4.9. Upgrade	32

SHENZHEN SYSOLUTION TECHNOLOGY CO., LTD

Install APP Instructions

For android phone : go to android APP store, search LEDOK lite and Install APP, remember to allow all the permissions for the APP during the installation.

Please visit this link for the video tutorial: [Android installation](#)

For IOS phone: go to APP store and search LEDOK lite and install APP, also allow all the permissions for the APP in the General settings.

Please visit this link for the video tutorial: [IOS installation](#)

Basic Instructions of the APP

Open LEDOK Lite, will see the interface in the below:

Function selection:

Choose Local Control and click Go button, Cloud control function is not open yet.

Basic setup including following items, see the screenshot in below:



Language: English, Chinese

Software version: 1.6.0 (will update in the future)

Software Update: click this "check for update" to install the latest version

Scanning code sharing: click the button and then a QR code will pop up, can share with others.



Help: Instruction Manual, user agreement, privacy policy and other functions, please see screenshot in the below.

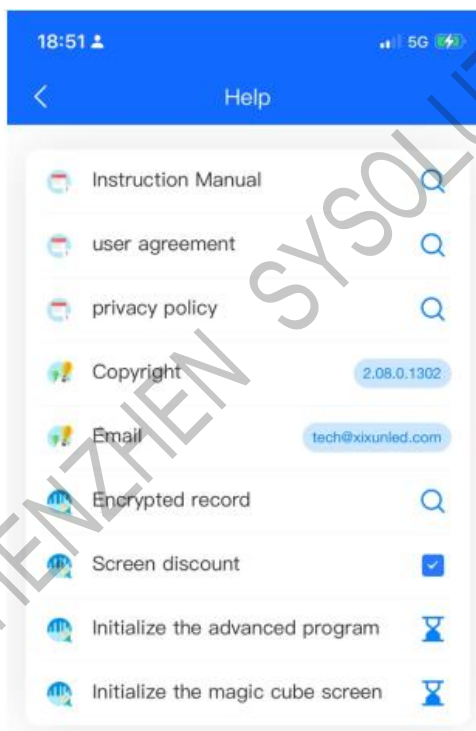

Instruction of Local Control

1. Detect controller IP address

Preparations:

Hardware: power on for the led controller and go to phone's WLAN and find controller hotspot, connect it, password is 12345678.

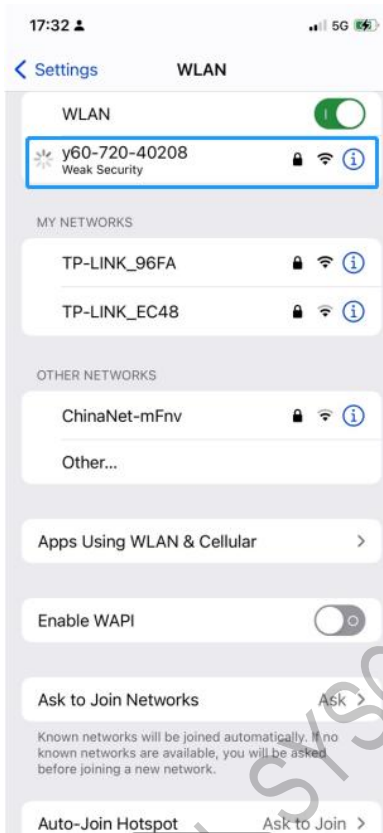

Click the Search button on the right top and will detect the controller IP, see the screenshot in below:

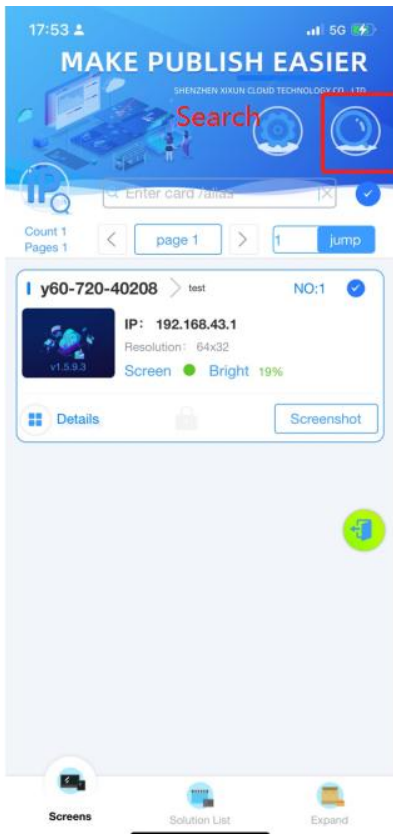

If can not search the IP, then click the IP search button in the left top, see the screenshot in below.



Enter the IP 192.168.43.and then click "Segment scanning" and waiting seconds then will find the IP : 192.168.43.1



Then click Off and click Search button again,will see the controller IP success. See screenshot in below:



1. controller serial ID.

2. screen resolution.

3. Click Details will get the controller some basic information.

4. Click Screenshot to get the current display image.

2. Solution List

In the bottom, will see Solution List, this is for making programs and publishing.

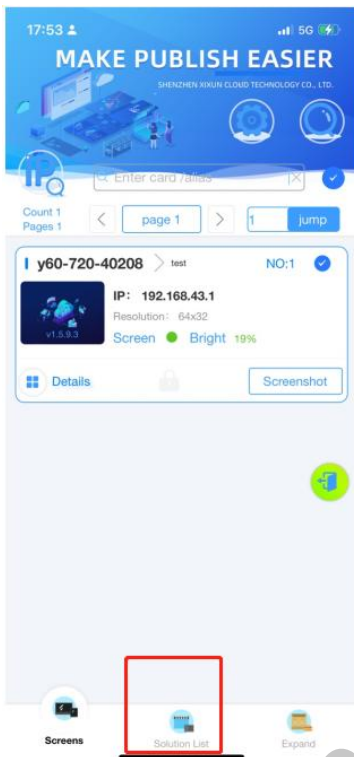

There are Add, Delete, Progress and Send buttons in the top, see screenshot in below:

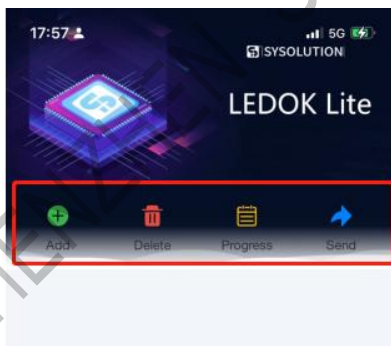

2.1. Add

Click Add button to add program task, set the task name. A program task will contain multiple

solutions.

Width: LED screen width pixels

Height: LED screen height pixels

(take 64X32 for example)

Then click OK. See screenshot in below:

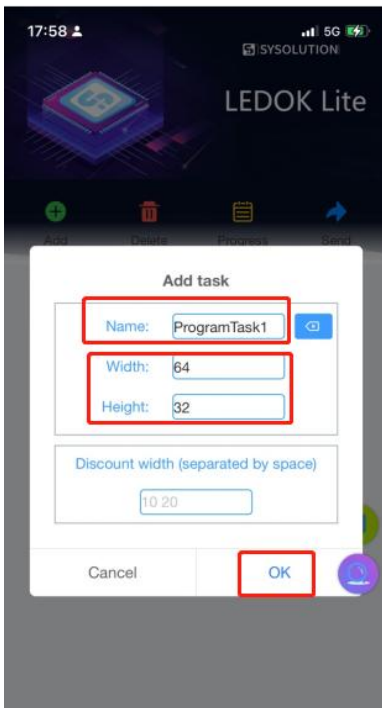

Click left button to add solution, customized the name and click OK, see screenshot in below:

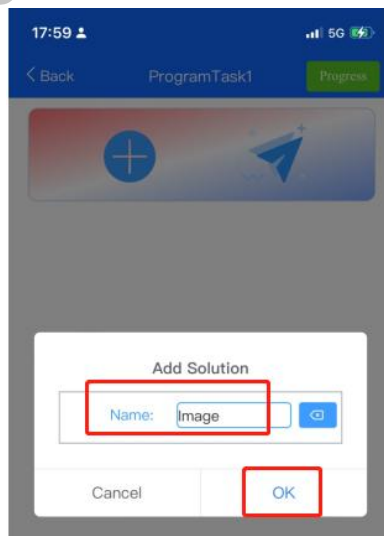

Click add button in the right and will see media types: image, video, text, analog clock, digital

clock, countdown, Environmental and Multiwindow.

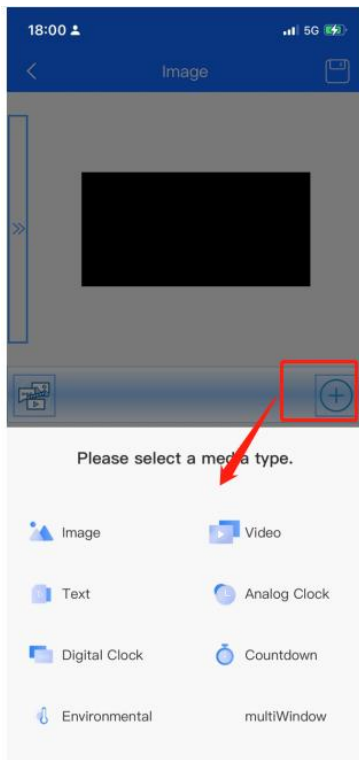

Take Image for example:

Choose image and you can open camera to take a photo immediately or choose a photo from Album, see screenshot in below:

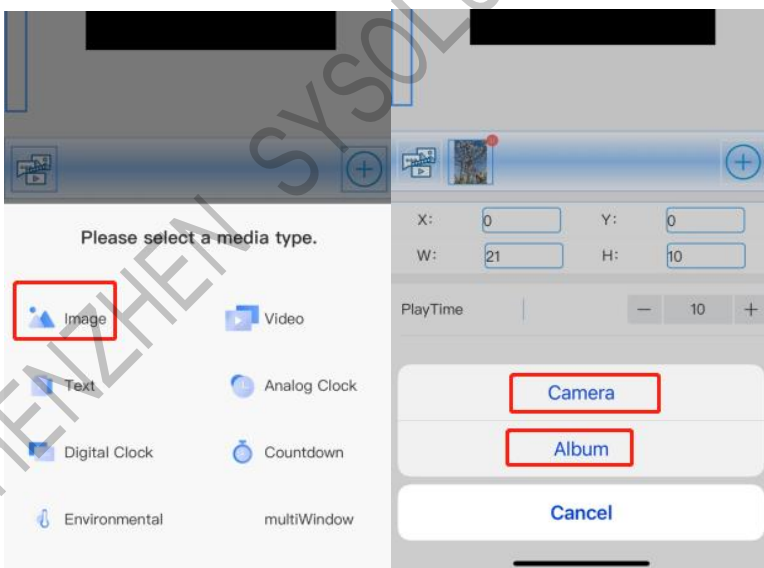

On the top can preview the image and can drag the photo to make it full size, the default PlayTime is 10 seconds.

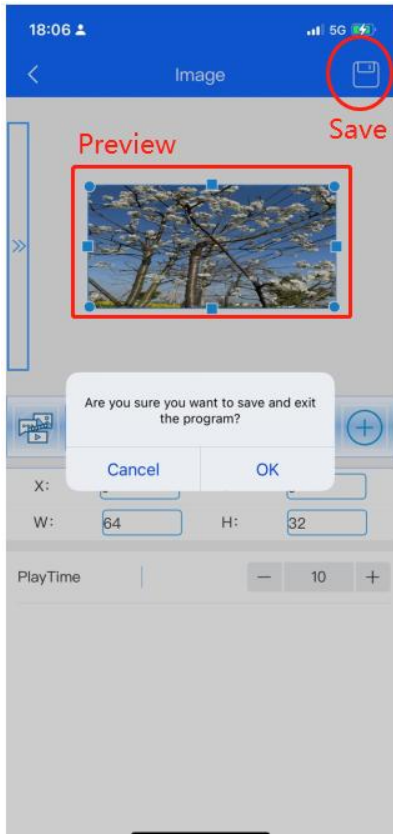

Then click save button on the right top, then a tip will pop up, click OK, see screenshot in below:



Then click Publish button, see screenshot in below:

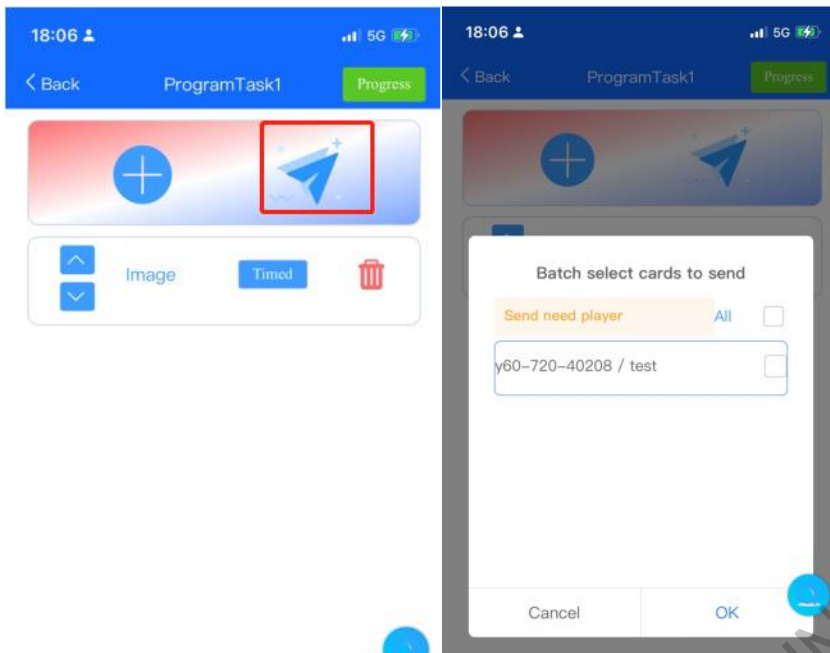

Select the controller and click OK, then waiting for 100% means send success.

If you want to send images and videos in one time, you can make Multiwindow, see screenshot in below:



Click the add button and choose image to add photo, choose video to add video, choose text

to add text message, all of them can be previewed on the top,

Then click send button after save.



2.2. Schedule for each solution

Click Timed button to enter the schedule arrangement, see screenshot in below:

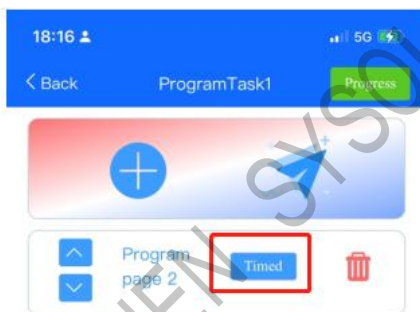

Click Add timing to set the date range, time range and week range, see screenshot in below:

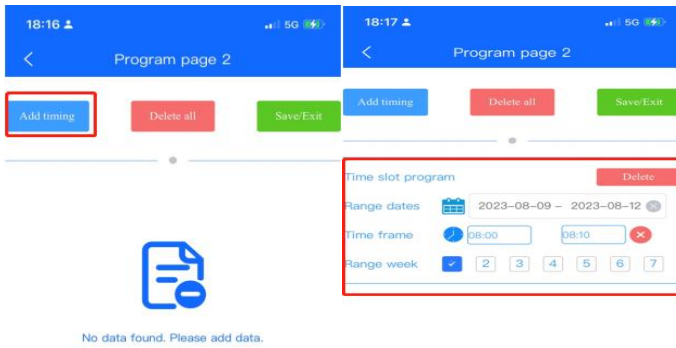

And then click save/exit button.

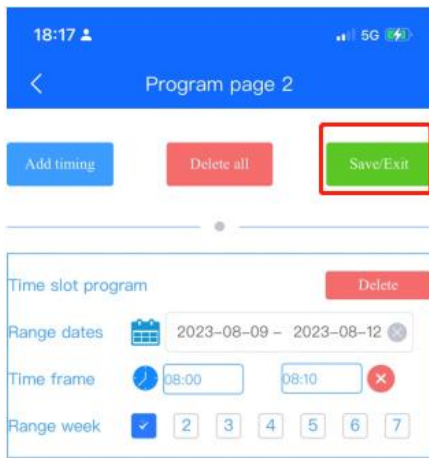

Need to Send program again after adding timing.

If you want to cancel the timing, please delete the settings and click Save/Exit.

Then send program solution again.



3. Expand

To view and use the expand functions, need to input password 888 to enabled, see screenshot in below:



3.1. Real-time Text

Realtime text will be on the top layer of the current display content, mainly for some emergency messages.



Editing the message in the frame and click Update button to modify the width and height according to your led screen resolution.

Click "Clear" button to cancel the realtime text.

For more instructions, please click the video tutorial link: [Real-time text](#)

3.2. Scoreboard

This function mainly for preview the interface and functions, for future use, we will provide professional scoreboard software. See screenshot in below:

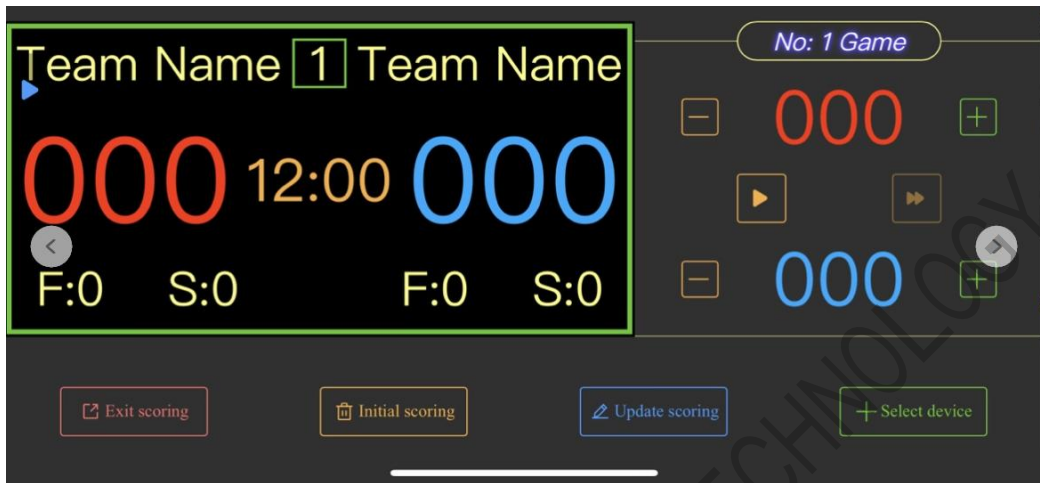

3.3. Magic cube



Please click the video tutorial link in below: [Cube screen](#)

4. Instructions of Settings

Through the settings, can make basic setup for the sign including the network, volume, brightness and others, see screenshot in below:

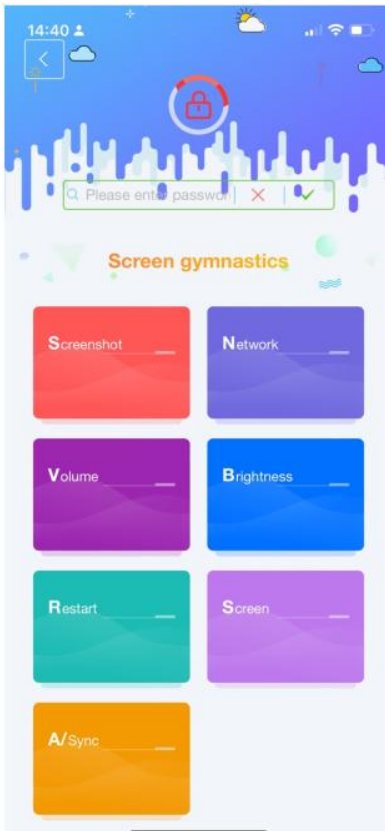

4.1. Screenshot

Select the controller that you want to operate, then click the Settings button. See screenshot in below:



Click the small green button to get the current display content on the led screen, see the screenshot in below:



4.2. Network

Open the drag box and select the Network to quick enter the settings, see screenshot in below:



4.2.1. Cable Network

When connect the led controller through the router via Ethernet cable to accessing to internet, then need set the cable network, can set DHCP IP or Static IP. See screenshot in below:

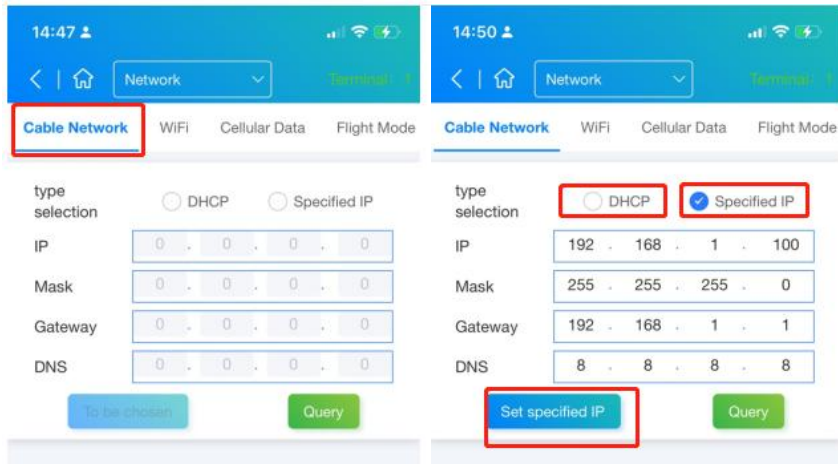

There is a Query button so that can readback the controller cable network type.

4.2.2. WIFI

WIFI enabled: let led controller connects to a office or a home wifi, then choose this.

Click scan and find the wifi name, and input the wifi password, click Set WIFI enabled, see screenshot in below:



AP enabled

Setup a customized AP name for the led controller and set the password, click Set AP Enabled.

See screenshot in below:



Please note that the AP will not work when the led controller accessing internet through WIFI.

AP will work when the led controller accessing internet through 4G data.

General

Read WiFi: click this button then will get the controller wifi status. See the screenshot in below:



Read Enabled: will readback the controller wifi name and status. See the screenshot in below:

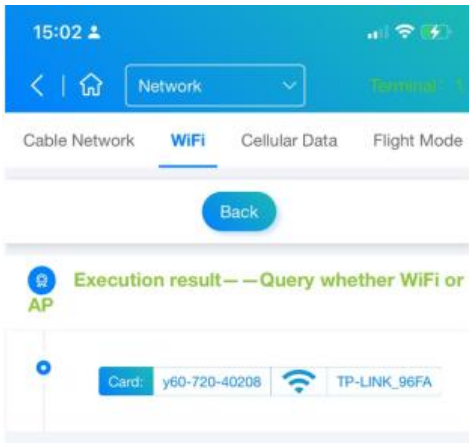

4.2.3. Cellular Data

Insert a SIM card into the led controller and then click Get cellular network to get the SIM status, see screenshot in below

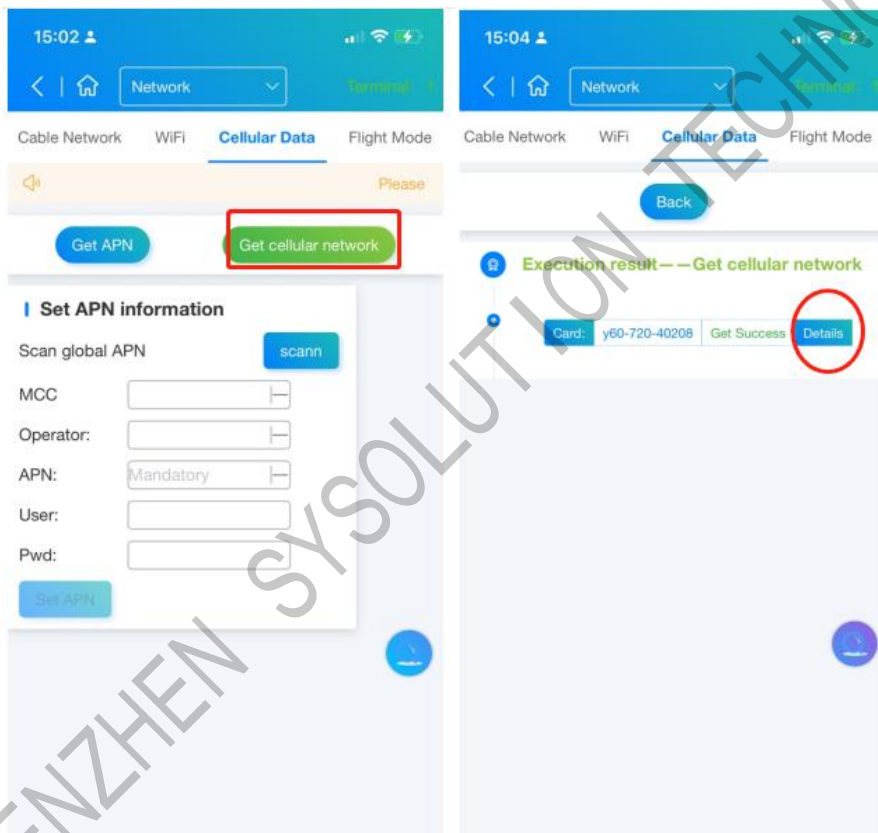

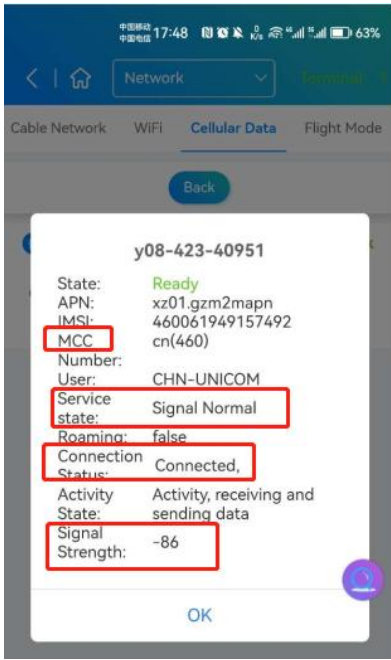

After that, choose the MCC , Operator, APN and click Set APN. See screenshot in below :



4.2.4. Flight mode

Can open and close Flight mode for the led controller when has 4G SIM card in it. Default is Close status.

See screenshot in below:

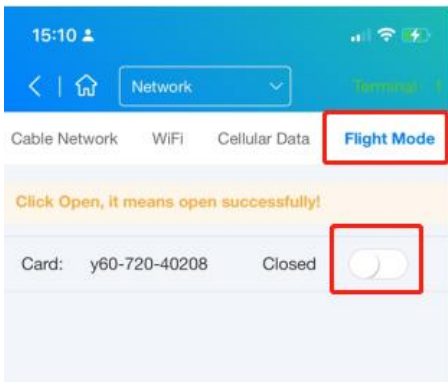

4.3. Volume

There are two methods to adjust volume:

Manual: range from 0 to 15. set the value and click Set

Click Query button to get the current volume number.

See screenshot in below:

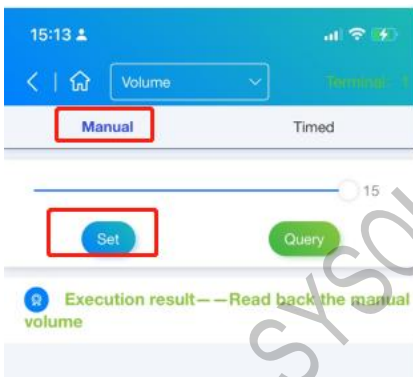

Timed:

Click Add timing and then set the a customized task name, then set the Default Volume number.

Then set the timing volume number and date range, time range and week range, see screenshot in below:

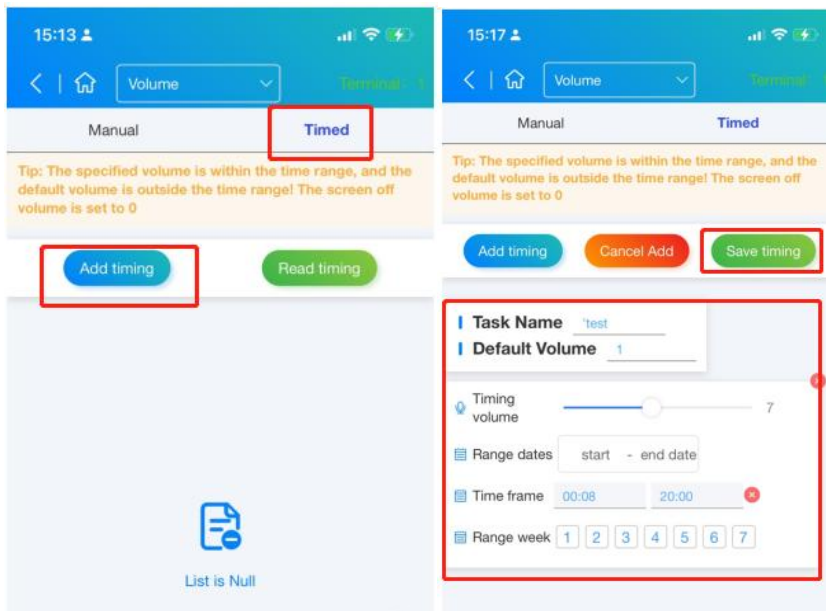

Default volume means except the timing volume, other balance time will keep at default volume.

After that, click Save timing.

Click Cancel Update to delete timing. see screenshot in below:

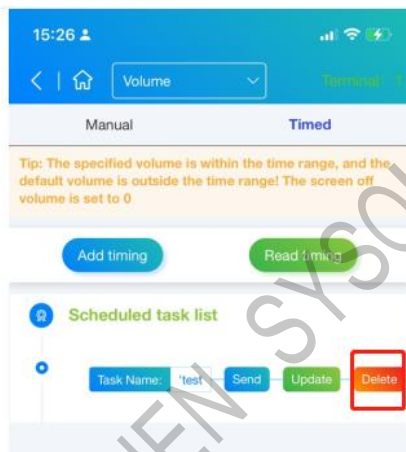

4.4. Brightness

Manual: range from 0 to 100. set the value and click Set

Click Query button to get the current volume number.

See screenshot in below:

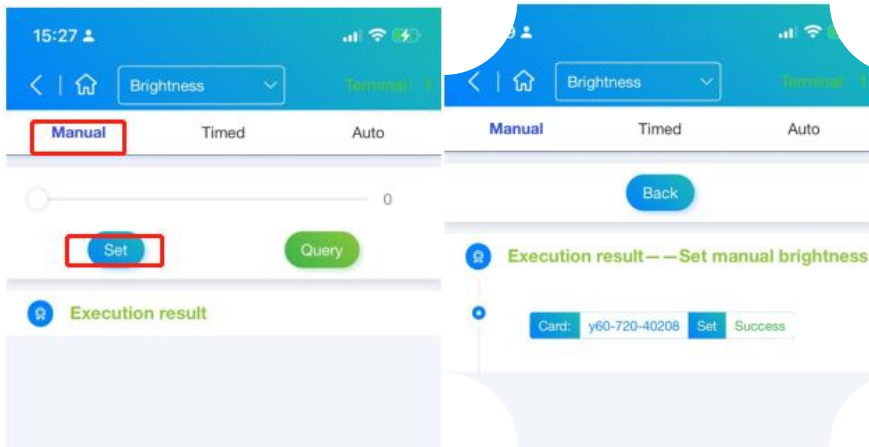

Timed:

Click Add timing and then set the a customized task name, then set the Default brightness number.

Then set the timing brightness number and date range, time range and week range, see screenshot in below:

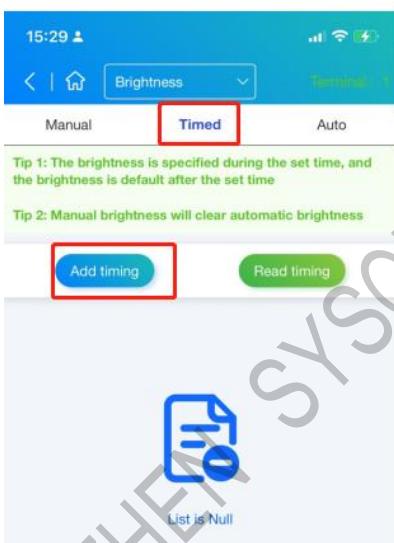

Default brightness means except the timing brightness,other balance time will keep at default brightness.

After that, click Save timing.

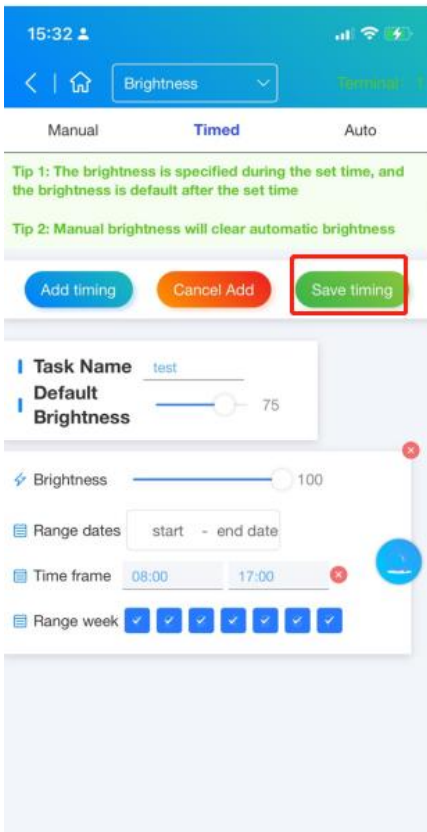

Click Cancel Update to delete timing.see screenshot in below:



Auto: when led controller connecting to a brightness sensor, please set the Auto

Please follow the instructions to set the sensitivity number, minimum brightness and maximum brightness and then auto brightness sensor will work. See screenshot in below:

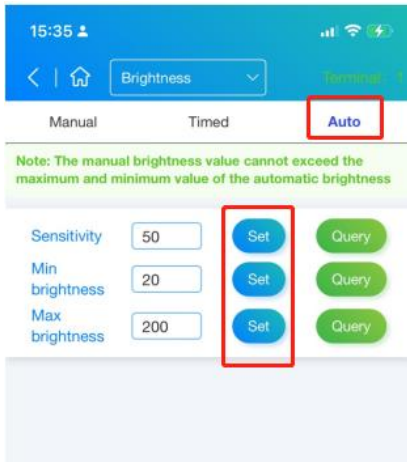

Support to Query each items.

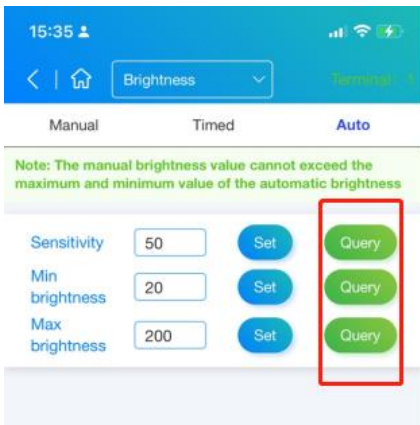

4.5. Restart

Manual: click the restart button and reboot the controller system, see screenshot in below:

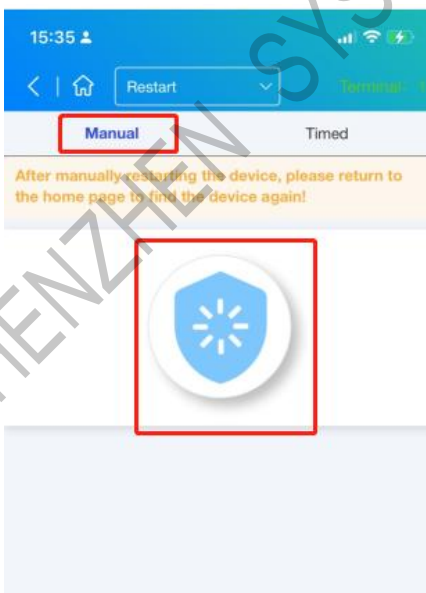

Timed: choose a time and then click set. Then the led controller will reboot itself at the specific time per day. See screenshot in below:

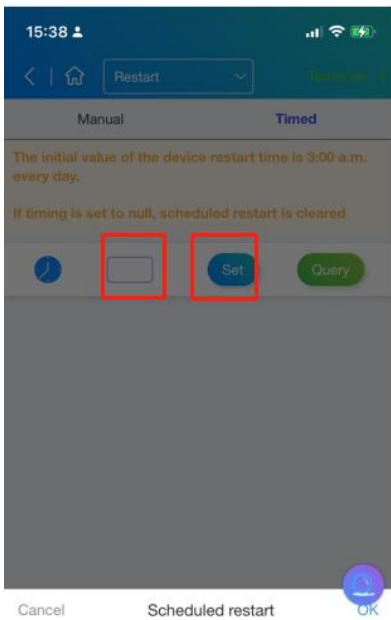

00	00
01	01
02	02

4.6. Screen

Manual: can open, off the led screen and can get the execution result immediately.

Support Query the screen status.

See screenshot in below:

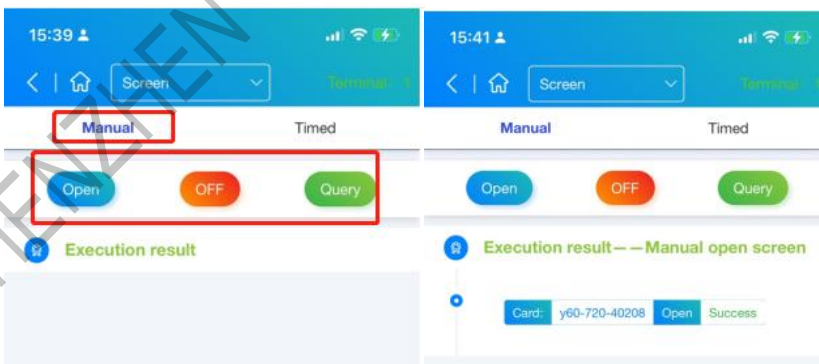

Timed: Click Add timing and then set the a customized task name, please note that the timing switch is for open status, the balance time will keep screen off.

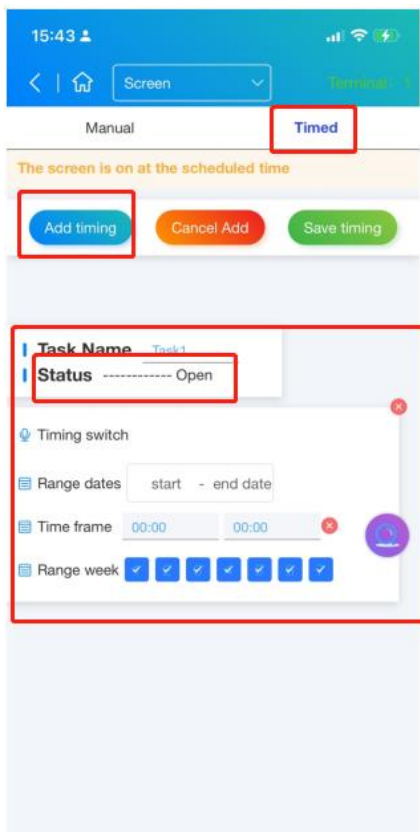

Then set the date range, time range and week range, see screenshot in below:

After that, click Save timing.

Click Cancel Update to delete timing, see screenshot in below:



4.7. Senior

Can update the screen width and height pixels

Set the alias name for the led controller.

See screenshot in below:

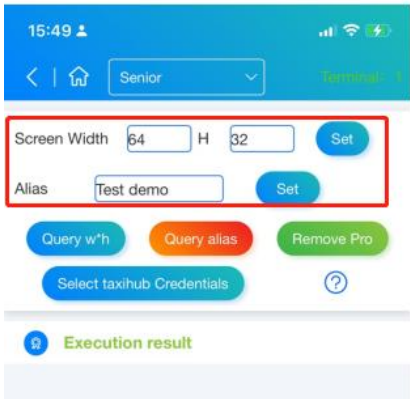

Select taxihub Credentials: this is for binding led controller to the Vehicle HUB platform.

Please download the token ic file in advance and saved in the cellphone files.

Click this button and open cellphone files and find the correct file and Set. See screenshots in below:

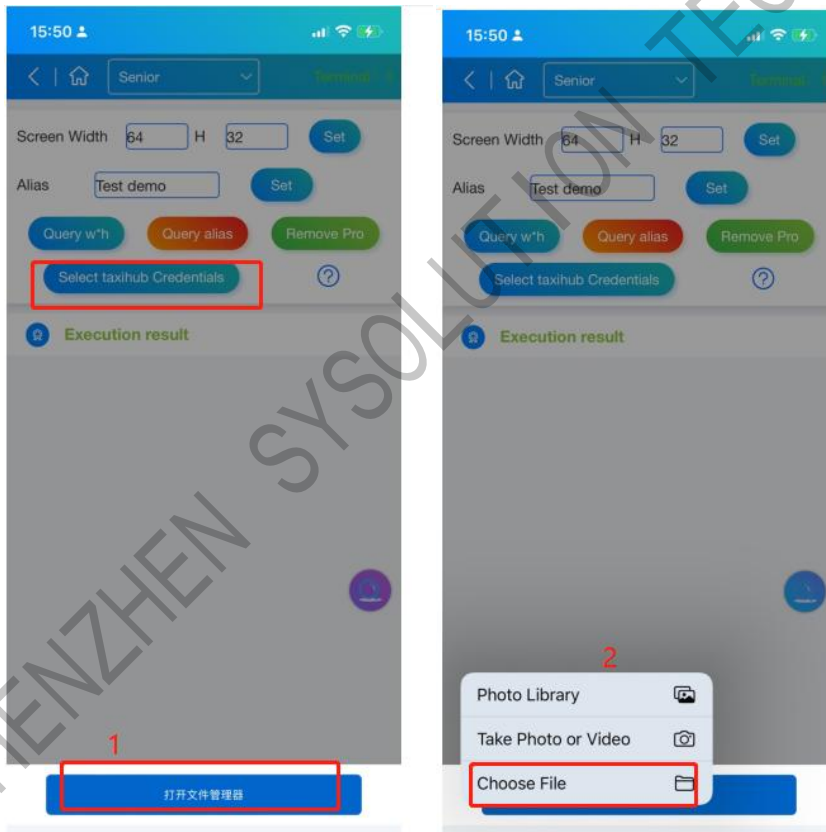

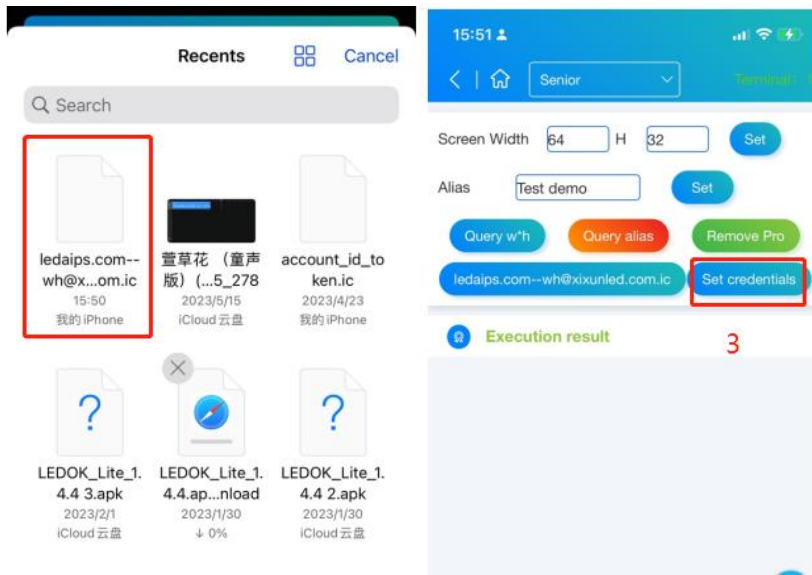

4.8. Server

Web server: can update the controller's web server address, choose the correct address and set.

Company ID: correct company ID

See screenshot in below:

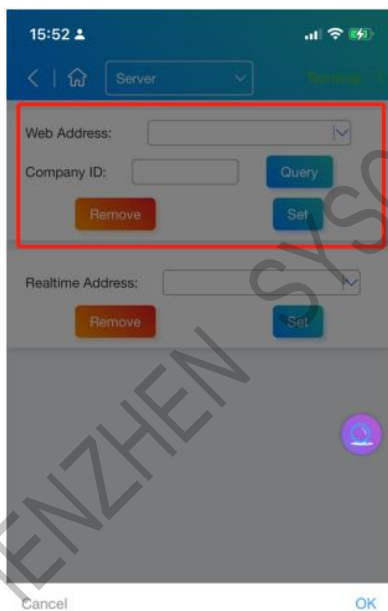

Realtime Address: the default is for ledokcloud platform(AIPS4.0).

Also support to input the customized Realtime server address for secondary development purpose.

See screenshot in below



4.9. Upgrade

Check APK: click this button and will get all the apk version for the selected led controller, see screenshot in below:

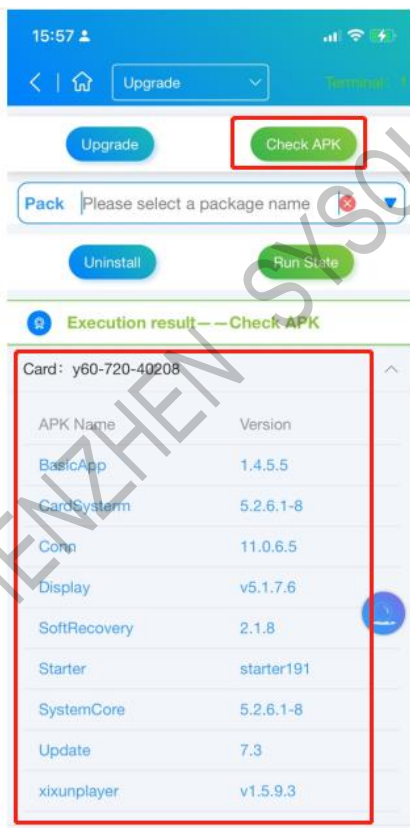

Upgrade: please contact our technical support to confirm the upgrade correct version. See screenshot in below:

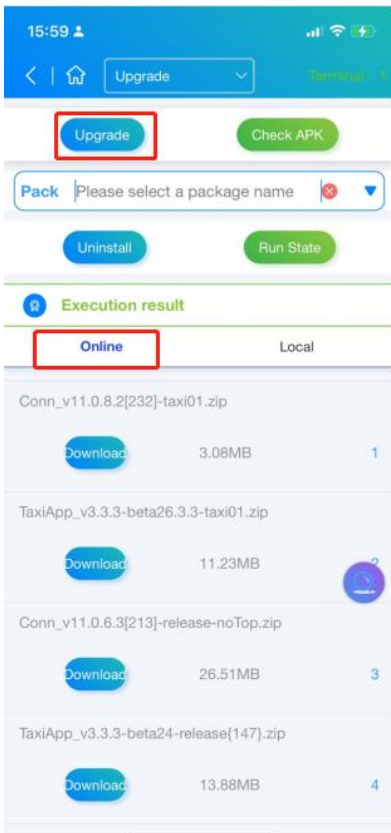

Uninstall: select apk name and click uninstall. Please contact our technical support before do any install APK operation!

See screenshot in below:

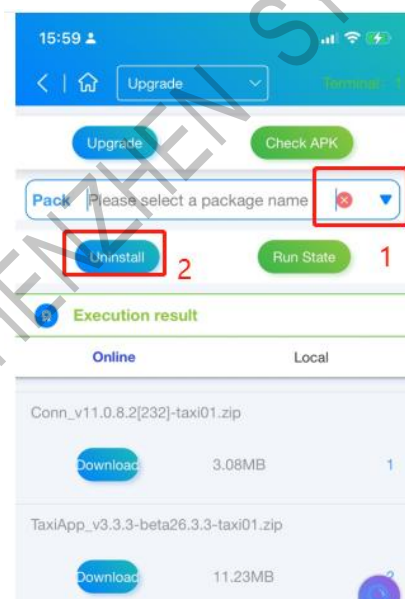

Switch taxi steps

Steps of Switch from xixunplayer to taxiapp.

Step1. Enter Upgrade interface and Check APK for the led controller, see screenshot in below:

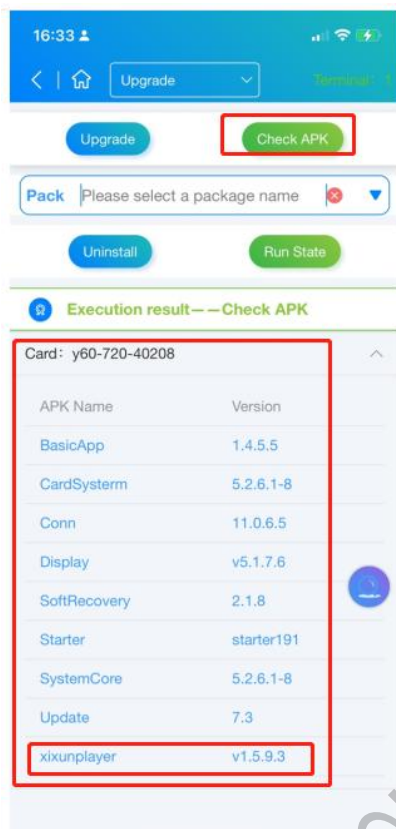

Step2, open the dropbox and choose com.xixun.xixunplayer and click Uninstall button, see screenshot in below:

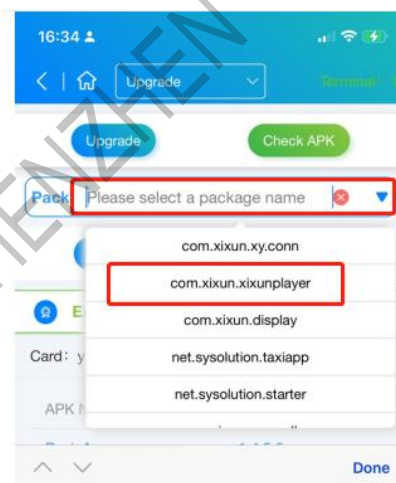

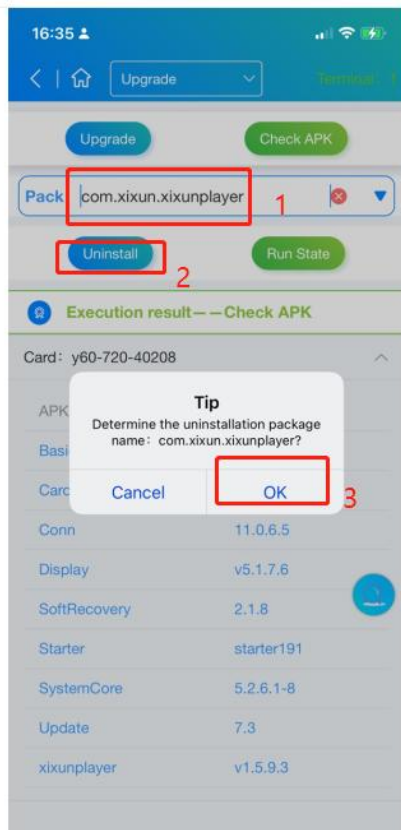

Step3, after uninstalling success, click Upgrade button, and find the Taxiapp version in the Online APK list, see screenshot in below:

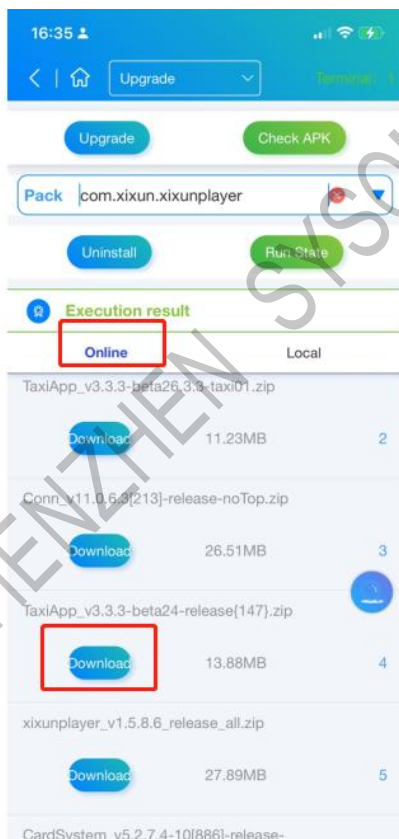

Step4, click Download and waiting for success, and then click Local and find the file, click

Upgrade button, see screenshot in below:

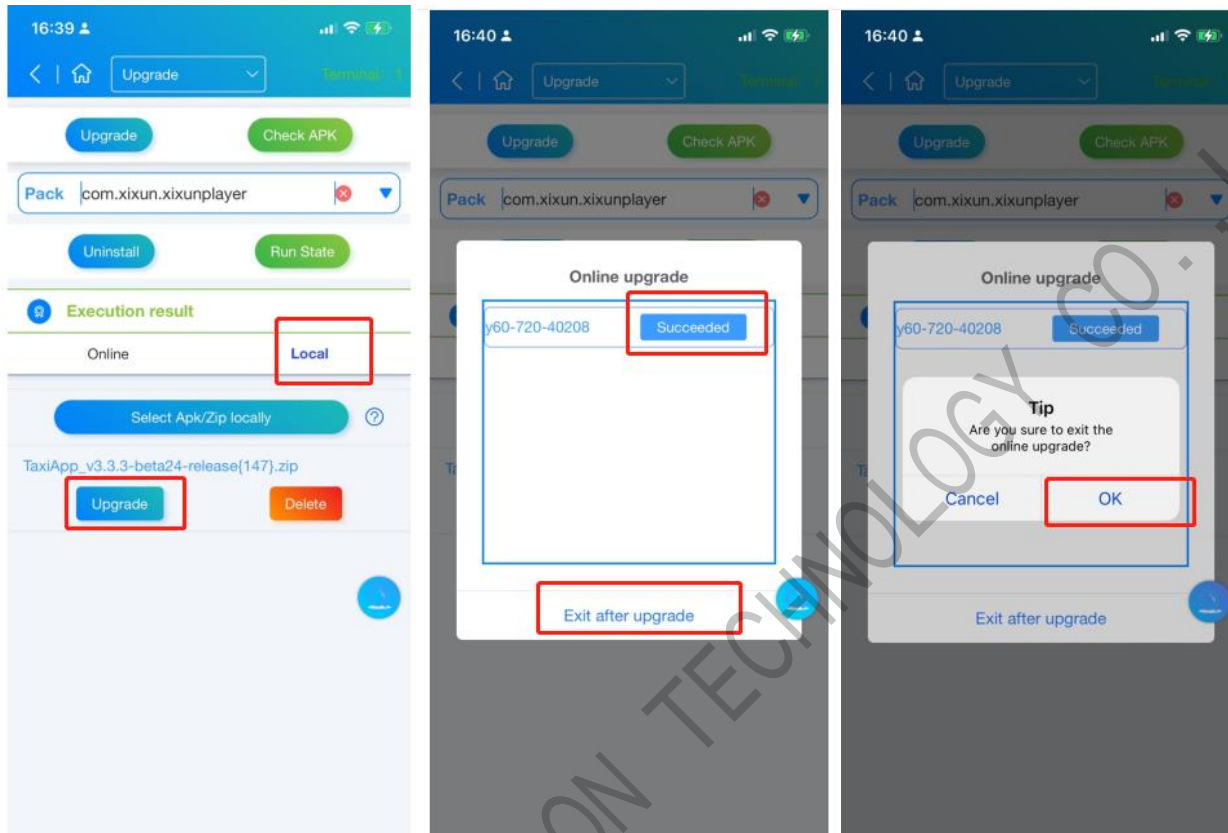

Step5, then click Check APK again and will see taxiapp is there. See screenshot in below:

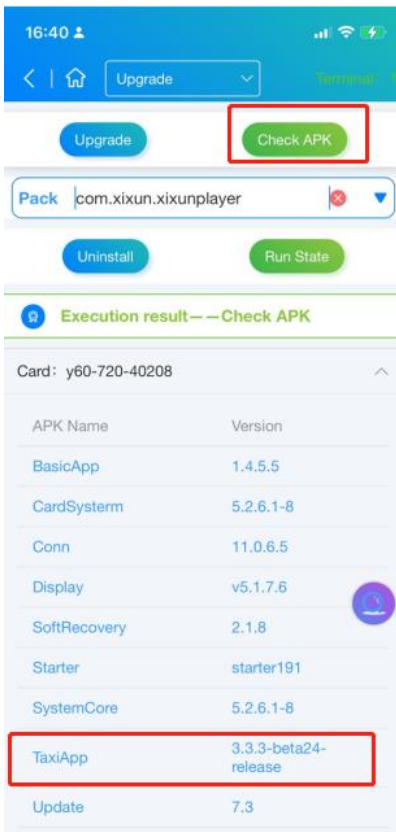

Step6, If you want to install Xixunplayer , then uninstall taxiapp first, and then choose xixunplayer 1586 and do upgrade success.

